

ওয়েষ্ট বেঙ্গল গ্রামীন ব্যাঙ্ক

(সরকারী মালিকানাধীন শিডিউল্ড ব্যাঙ্ক)

মোরাপোড়া চৌপাঠী, দিনহাটা রোড

পোঃ কোচবিহার, জেলা - কোচবিহার

পশ্চিমবঙ্গ - ৭৩৬১০১, ভারত

ওয়েবসাইট: <http://www.wbgb.co.in>



West Bengal Gramin Bank

(Scheduled Bank Owned by Government)

Morapora Chowpathi, Dinhata Road

Po. Coochbehar, Dist - Coochbehar

West Bengal 736101, India

Website: <http://www.wbgb.co.in>

Date: 30.04.2026

**TENDER INVITATION**

Sealed tenders are invited by Regional Office-West Bengal Gramin Bank, Dinhata Road, Morapora Chowpathi, Coochbehar - 736101, West Bengal for its Saheberhat Branch to execute composite work which includes ELECTRICAL work under (Two) bid System i.e. Technical Bid (Cover-I) & Price Bid (Cover-II).

**Name of Work:** ELECTRICAL works of SAHEBERHAT BRANCH of West Bengal Gramin Bank.

**Cost of Tender Document:** ₹500/- (Rupees Five Hundred Only) to be paid by demand draft or Banker's Cheque favoring West Bengal Gramin Bank, Regional Office- Coochbehar, Payable at Coochbehar.  
**(Non Refundable)**

**Availability of Tender Documents:** West Bengal Gramin Bank, Regional Office Dinhata Road, Morapora Chowpathi, Coochbehar-736101, West Bengal  
OR  
[wbgb.co.in](http://wbgb.co.in)

**Issue of the Tender Documents:** From 30.04.2026 to 18.05.2026 between 10:00 Hrs. to 15:30 Hours, Except Sundays and Holidays.

**Time & date of Submission of Tender:** Up to 3:00 P.M. on 18.05.2026

**Time and Date of Opening of Tender:** 12:30 P.M. on 19.05.2026

**Venue of the Tender opening:** West Bengal Gramin Bank Regional Office, Dinhata Road, Morapora Chowpathi, Coochbehar-736101, West Bengal

**Tender to be addressed to:** To,  
The Regional Manager  
West Bengal Gramin Bank  
Regional Office  
Dinhata Road, Morapora Chowpathi,  
Coochbehar-736101,  
West Bengal

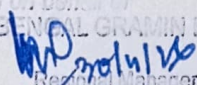
For and on behalf of  
WEST BENGAL GRAMIN BANK  
  
Regional Manager  
Regional Office, Cooch Behar

## Earnest Money:

₹ 5000/- (Rupees Five Thousand Only)

EMD shall be accepted in form of Insurance Surety Bonds, Account Payee Demand Draft, Fixed Deposit Receipt, Bankers' Cheque or Bank Guarantee (including e-Bank Guarantee) (from any Scheduled Commercial Bank other than our own Bank) or online payment

Tender without the Earnest Money in proper form shall be rejected. In accordance with the Government of India Guidelines MSME are exempted from payment of EMD upon submission of valid MSME certificate copy which has to be certified by competent authority.

It may be noted that startup vendors (which are not MSME) are eligible for exemption from payment of Security deposit/ EMD subject to they are submitting requisite certificate of having been recognized as startup.

Delay in submission of any part arising due to postal or any other irregularities at any stage will not be considered. The Bank will not be responsible for any damage in transit in case of postal delivery/ delivery through courier service.

## Delay in submission:

## Defect Liability Period:

12 (Twelve) months from the date of issue of completion certificate.

## Date of Commencement:

Either one week from the date of Work Order or the day on which the contractor is instructed to take possession of the site, whichever is earlier.

## Period of Completion:

30 Days from the starting of the work.

## Validity of the Tender:

3 (Three) calendar months from the date of submission of Tender

## MODE OF SUBMISSION

The tender is to be submitted in one envelope having both the separate sealed envelopes I & II being put in the this one envelope and should be sealed properly and addressed to "The Regional Manager, West Bengal Gramin Bank, Regional Office, Dimhata Road, Morapora Chowpathi, Coochbehar-736101, West Bengal". Ph. No. & mail id of the vendor should be mentioned on the main envelope.

## ENVELOPE 1: (MARKED As ENVELOPE I)

This envelope shall contain the following:

- Forwarding letter on bidder's letter head pad without mentioning the cost of Tender value arrived at with quoted rates,
- Registration / MOA of Firm,
- Work Order / Completion of Work Certificates for Similar kind of work (if available). Tenderer with experience will be given preference.
- Work Order of major projects on which the firm is engaged at present if available.
- Copy of PAN Card,
- Copy of GST Certificate,
- Copy of Trade License,
- License (Form E) issued by Govt. of West Bengal as Electrical Contractors.
- Pay Order / Banker's Cheque / DD of tender fees & EMD.
- Tender document sign & stamped on each page.

For and on behalf of  
WEST BENGAL GRAMIN BANK  
Regional Manager  
Cooch Behar

**ENVELOPE-2: Price Bid (MARKED AS ENVELOPE II)**

This ENVELOPE shall contain the following

Envelope Marked II shall contain the Price Bid submitted on the printed Forms issued by the bank. The tenderer shall quote the final amount in both figure and words.

Terms & Conditions:

1. Quotation will be considered on lower rate ( L1) basis.
2. After expiry of scheduled time frame no quotation will be accepted.
3. Bank authority reserves the right to accept or cancel bid unilaterally without assigning any reason thereof prior to the placement or supply order/signing contract thereby.
4. Delay or deviation in work material or time may attract penalty on bill amount.
5. GST no. is mandatory to submit quotation.
6. Rates will be inclusive all charges except GST.
7. Tenderers are advised to visit the branch site to assess the scope of work.
8. Uncompromising adherence to material and workmanship quality standards is required.
9. Vendors should preferably have an established office unit in North Bengal.

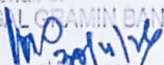
For and on behalf of  
WEST BENGAL GRAMIN BANK  
  
Regional Manager  
Regional Office, South Behar

# ROAD

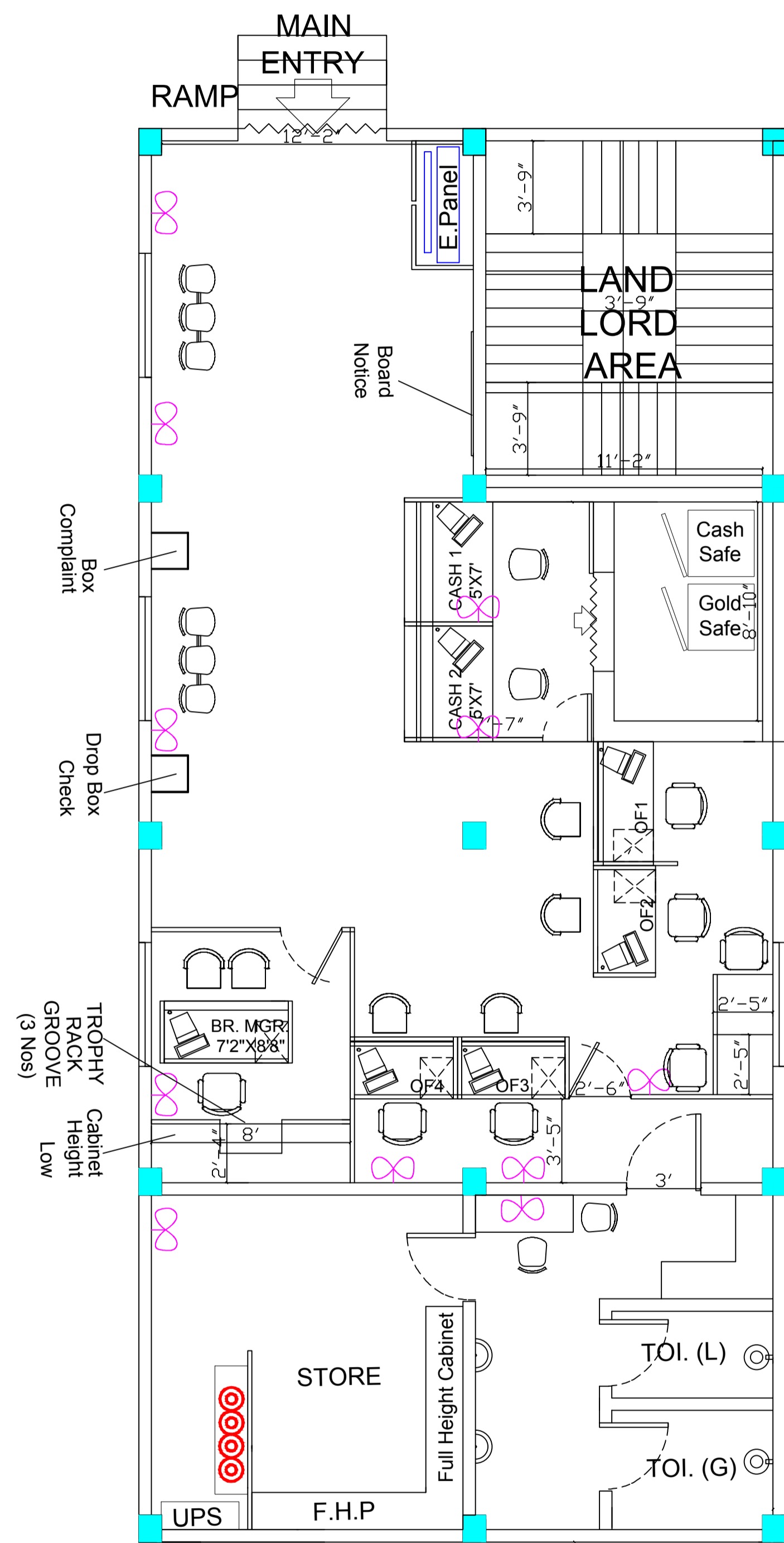

CIVIL DWG.

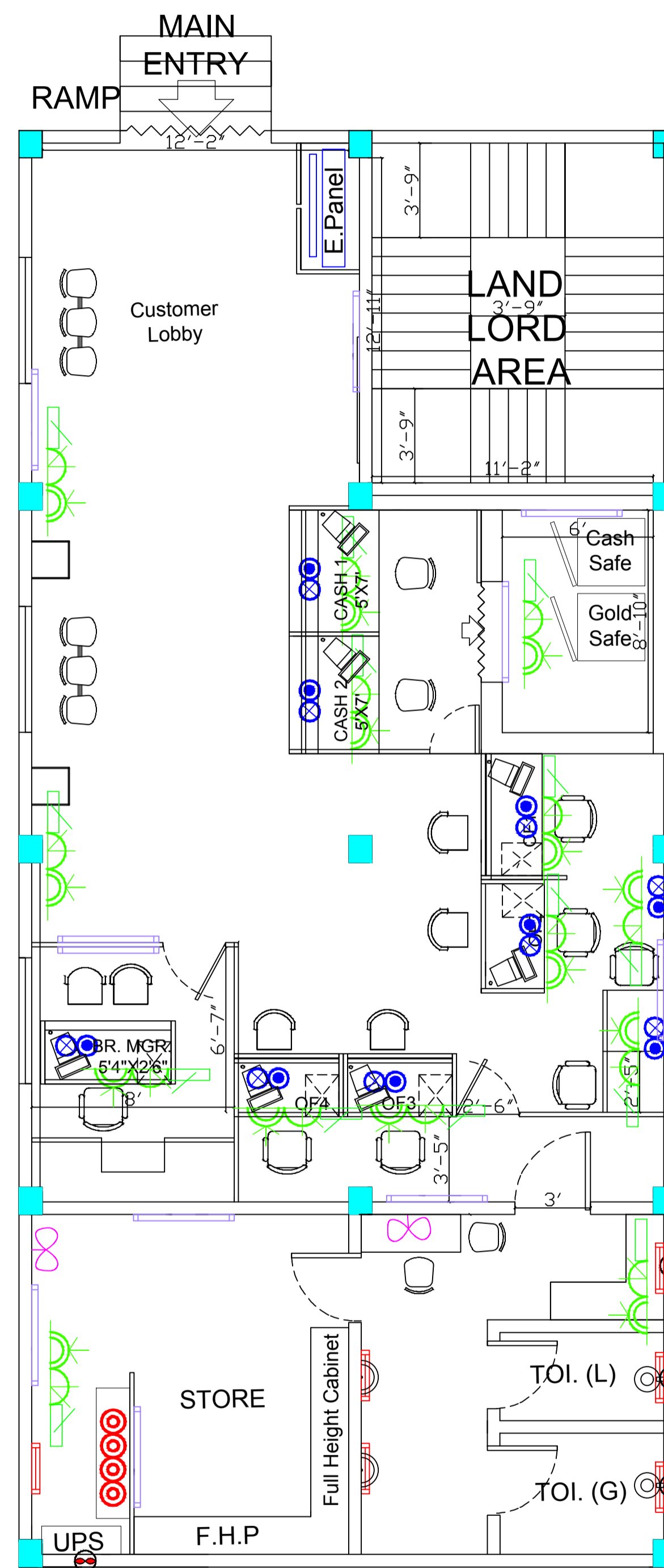

ELECT. DWG.

## LEGEND

| FIXTURE               | SYMBOL | NO. |
|-----------------------|--------|-----|
| DOWN LIGHT            |        | 00  |
| RECESS LIGHT          |        | 00  |
| TUBE 4'               |        | 11  |
| TUBE 2'               |        | 06  |
| CALL BELL             |        | 00  |
| EXHAUST FAN           |        | 04  |
| WALL BRACKET FAN      |        | 11  |
| SWITCH BOARD          |        | 14  |
| 16 amp PLUG POINT     |        | 14  |
| 6 amp PLUG POINT      |        | 14  |
| COMPUTER & LAN POINT  |        | 09  |
| TELEPHONE             |        | 00  |
| RAW POINT IN UPS      |        | 04  |
| PANEL                 |        | 01  |
| A.C. STARTER & SOCKET |        | 00  |

PROJECT:

WEST BENGAL GRAMIN BANK  
SAHEBERHAT BRANCH

AREA STATEMENT:

PREMISE IN USE :  
AREA AGREEMENT: 1200 SQ.FT  
AREA (EXCL. WALLS): 1223.90 SQ.FT  
TOILET AREA (G & L): 91.75 SQ.FT  
AREA (INT. WALL): 27.37 SQ.FT  
COLUMN AREA(INT.): 1.98 SQ.FT  
CARPET AREA (EXL. WALLS, TOILET & INT. COLUMN): 1102.8 SQ.FT

PROJECT ENG.

M/s PAUL DESIGNING CONSULTANTS  
OFFICE ADDRESS:  
NILKUTHI, RAILGHUMTI  
Phone - +91-7430940271

©2025. ALL RIGHTS RESERVED BY PAUL DESIGNING CONSULTANTS

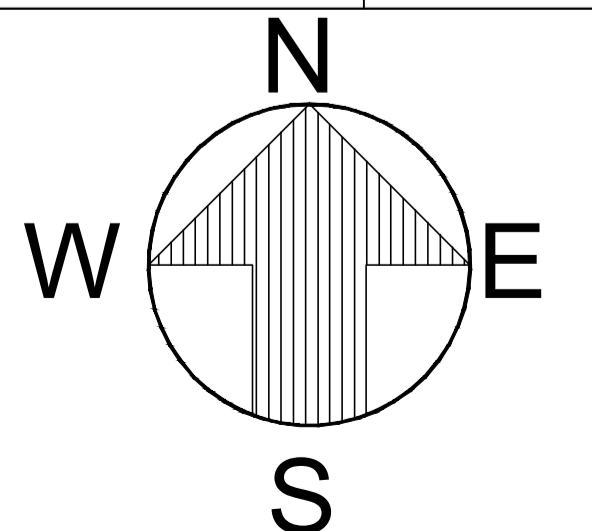

**BOQ of Proposed Interior & Furnishing Work of West Bengal Garmin Bank, Saheberhat Branch**

**SCHEDULE OF QUANTITIES FOR ELECTRICAL & DATA CABLING WORKS**

| <b>SL No.</b> | <b>DESCRIPTION</b>  | <b>QTY</b> | <b>UNIT</b> | <b>RATE</b> | <b>AMOUNT</b> |
|---------------|---|------------|-------------|-------------|---------------|
| <b>1</b>      | Distribution wiring in 2x22/.3(1.5 sqmm)single core stranded 'FR' PVC insulated & unsheathed copper wire (approved make) in 20mm size PVC rigid conduit 'FR' (precision make) with 1x22/0.3(1.3 sqmm) single core stranded 'FR' PVC insulated & unsheathed copper wire ECC with all accessories embedded in wall/ceiling, to light/fan/call bell points with Modular type wick fixed on GI switch board on well complete with 2 no. suitable size "Ph & N" copper bar with holes fixed on Bakelite/hard rubber insulation over the f8 welded chairs incl. Modular (wall matching colour) lop cover 3 mm thick and incl. suitable size inspection box making carting enactment painting the GI box and mending good the damages. | <b>40</b>  | <b>Pts.</b> |             |               |
| <b>2</b>      | Distribution wiring in 1.1 KV grade 2x22/.3( 1.5 sqmm)single core sanded 'FR' PVC insulated & unsheathed copper wire (approved make) in 20mm size PVC rigid conduit 'FR' (precision make) with 1.1 KV god 1x22/0.3(1.5 sqmm) single core stranded 'FR' PVC insulated & unsheathed copper wire as ECC with all accessories embedded in wall. the A modular socket & Modular type switch fixed on GI switch board incl. modular (wall matching colour) top cover 3mm thick and incl. paining the GI box and mending good the damages to original finish.  | <b>30</b>  | <b>Pts.</b> |             |               |
| <b>3</b>      | <b>SUPPLY FITTING &amp; CONNECTION LIGHT FITTINGS/FANS</b>  |            |             |             |               |
| <b>a</b>      | <b>2' LED TUBE BE or Similar approved of Philips/Havells/ Crompton Greaves (with all accessories)</b>   | <b>10</b>  | <b>Each</b> |             |               |
| <b>4</b>      | <b>COMPUTER DATA SYSTEM/LAN WIRING</b>  |            |             |             |               |
| <b>a</b>      | Supplying and Laying of CAT-6 cable through suitable size PVC casing capping from server to HUB,HUB to Computer Data Socket including interconnection mending good etc. as required (Make - Havells / Finolex / Polycab/ KEI)   | <b>75</b>  | <b>mtr.</b> |             |               |
| <b>b</b>      | Supply and fixing on wall/furniture/ partition recessed non-modular type Computer data socket (D-Link make) with mounting box & front plate as shown in the drawing complete with mending good etc. as required. (Make - L&T / Anchor-Panasonic/ Crabtree/ Legrand) ( For BM-2 points)  | <b>6</b>   | <b>Each</b> |             |               |
| <b>5</b>      | <b>MAIN LINE WIRING</b>   |            |             |             |               |
| <b>a</b>      | Supply and laying 4x 10 sqmm + 1 x6sqmm PYC insulated eloper wire from panel board to LDB (Make havells / Finolex / Polycob/ KEI)   | <b>60</b>  | <b>mtr.</b> |             |               |
| <b>b</b>      | Supply and laying 2x6sqmm+1x4sqmm PVC insulated copper wire 6om Panel board to CDB (Make - havells / Finolex / Polycab/ KEI)  | <b>40</b>  | <b>mtr.</b> |             |               |
| <b>c</b>      | Supply and laying 2x4sqmm+1x2.5sqmm PVC insulated copper wire from MCB DB to power plug (Make - Havells / Finolex / Polycab/ KEI)   | <b>80</b>  | <b>mtr.</b> |             |               |

|          |  |           |             |  |  |
|----------|--|-----------|-------------|--|--|
| <b>d</b> | Supply and laying <b>2x2.5sq.mm+ 1x1.5sqmm</b> peek <b>insulated eloper wire</b> from SPN <b>MCB DB to switch boards (M ate - Havells / finolex / Polycab/ KEI)</b>  | <b>30</b> | <b>mtr.</b> |  |  |
| <b>e</b> | Supply and lay in 2x6sq.mm+1x10sqmm pave insulated eloper wire (Make - Havells / Finolex / Polycab/ KEI)   | <b>20</b> | <b>mtr.</b> |  |  |
| <b>f</b> | Supplying and fixing 250V 6 pin 16A <b>modular plug</b> socket with 16A modular switch and earthing attachment incl. S&F sheet GI box. modular plate and necessary earthing attachment. (Make - L&T/ Anchor-Panasonic/ Crabtree/ Legrand)  | <b>10</b> | <b>Each</b> |  |  |
| <b>6</b> | <b>RAW POINT WIRING</b>  |           |             |  |  |
|          | Supply and laying 2x6 sqmm+ 1x4 sqmm PVC insulated copper wire MCB DB TO RAW POINT ) (Make - Havells/ Finolex/ Polycab/ KEI  | <b>80</b> | <b>mtr.</b> |  |  |
| <b>7</b> | <b>UPS WIRING</b>  |           |             |  |  |
| <b>a</b> | Supply fixing & connection of UPS circuit line with 1.1 kv grade PVC insulated non sheathed stranded copper cable of(FRLS) with 2x2.5sqmm+1x 1.5sqmm through rigid PVC conduit 20 media 1.6mm wall thickness, with ISI marks, to lay from UPS MCB DB to plug point board. Two nos. point to be connected from One circuit. (Ma key - Havells /Finolex/ Polycab/ KEI)                       | <b>80</b> | <b>mtr.</b> |  |  |
| <b>b</b> | Supply, fabrication & fixing of computer board made of 2 nos 5 pin 6 A modular socket & 1 No. 5 pin 16 A socket along with 6A & 16A individual switches having fixed with 1 No.LED indicator and 1I No. board fuse on suitable size GI switch board connection & recessed in wall with mending good all damages as per direction of EIC. (Make - L&T/ Anchor-Panasonic/ Crabtree/ Legrand) | <b>6</b>  | <b>set</b>  |  |  |
| <b>c</b> | Supply, installation, testing & commissioning of Legrand make 32A-3pin wall mounted, industrial type metal clad socket with plug top & 32A SPN MCB control (For UPS Room) (Make - L&T / Anchor-Panasonic/ Crabtree)  | <b>2</b>  | <b>Nos.</b> |  |  |
| <b>d</b> | Supply laying & connection of UPS incoming power line with 2x10sqmm + 1x6sqmm PVC insulated stranded copper wire from PANEL BOARD to UPS incoming power switch. (Make - Havells / Finolex Polycab/ KEI)  | <b>30</b> | <b>mtr.</b> |  |  |
| <b>e</b> | Supplying and fixing 32A change over switch. (Make- L&T/ Anchor-Panasonic/ Crabtree/ Legrand)  | <b>1</b>  | <b>Nos.</b> |  |  |
| <b>8</b> | <b>EARTHING</b>  |           |             |  |  |

|           |   |           |             |  |  |
|-----------|---|-----------|-------------|--|--|
| <b>a</b>  | Earthing with Copper plate (10x6 10x3mm size) having weight of 9.84 Kg and 1 No. 25x5mm Copper strip (3.20 mt. long) & 1 no. 6 sqmm PVC insulated stranded Copper wire (4 Mt long) incl. S & F 15 mm dia GI pipe (ISI-Medium) protection (4 mt. long) to be failed with bitumen, partly under the ground level & partly above ground level to an average depth of 3.65 Mts. below the ground level and restoring the surface duly rammed incl. providing 3.0 mt. long, 25 mm dia GI pipe (ISI-Medium) for periodic treatment, incl. providing masonry enclosure on the top of the earth electrode of overall size 86.36x86.36x46cm deep (below Ground level) complete with cemented brick work (1:6) of 25 cm width, duly plastered with cement mortar (inside) Cal hinged inspection cover of size 36.56x35.56cm with locking arrangement, GI reducer and treatment of soil by using salt & charcoal or coke for plate electrode. (1 No. For Main Panel & 1 No. For UPS) | <b>2</b>  | <b>Nos.</b> |  |  |
| <b>b</b>  | Providing and fixing Copper Earth Wire 8 gauge in PVC conduit in floor/ walls from earth pit to earthing station & finally connected to Main Panel Board complete   | <b>60</b> | <b>mtr.</b> |  |  |
| <b>c</b>  | Providing and fixing Pipe Earthing (IS 3043 Code) 3.0m. deep with 40 mm. dia. GI pipe With perforations filed with alternate layers of Charcoal and salt. The item includes Funnel on top in brick masonry chamber with CI cover for watering purpose complete.   | <b>2</b>  | <b>set</b>  |  |  |
| <b>9</b>  | <b>MAIN ELECTRICAL CUBICAL PANEL</b>  |           |             |  |  |
|           | i) 500 V 100 A TPN HRC fuse- 1  | <b>1</b>  |             |  |  |
|           | ii) 500V 63A TPN HRC fuse - 1   | <b>1</b>  |             |  |  |
|           | iii) 500V 63A TPN on Load change over switch - 1  | <b>1</b>  |             |  |  |
|           | iv) 500V 100 A bus bar Cu with BBC on heavy duty porcelain chairs- 2 set  | <b>2</b>  |             |  |  |
|           | v) 500 V 63 A FP MCB -2 Nos   | <b>2</b>  |             |  |  |
|           | vi) 230V/415 V 40A( 10KA) SP MCB- 4 No.   | <b>4</b>  |             |  |  |
|           | vii) 230V/415V 25A (10 KA) SP MCB-1 and HAVELLS XPRO (glow sign board )   | <b>1</b>  |             |  |  |
|           | viii) 0-100 Aammeter with selector switch - 1 set   | <b>1</b>  |             |  |  |
|           | ix) 0-500V Voltmeter with selector switch - 1 set   | <b>1</b>  |             |  |  |
|           | x) 100/5 CT- 3 Nos  | <b>3</b>  |             |  |  |
|           | xi) LED Indicator lamp - 3 Nos  | <b>3</b>  |             |  |  |
|           | xii) Medium pressure caution Board - 1 No.  | <b>1</b>  | <b>set</b>  |  |  |
| <b>10</b> | Main Incoming Switch Fuse Unit. Supply fixing of 100 Amps TPN HRC type SFU at WBSEB end for main incoming on MS angle. Frame & 02 nose Cable end box including connection.  | <b>1</b>  | <b>set</b>  |  |  |
| <b>11</b> | <b>COMPUTER DISTRIBUTION BOARO</b>  |           |             |  |  |
|           | Supply & installation of following HAVELLS/ LEGRAND make 12 way TPN MCB distribution board with MCB having short circuit breaking capacity of 10KA or RCBO of 100 mA sensitivity having overload short circuit & earth leakage protection complete with neutral, phase & earth bar with 1 No. 40A DP RCBO as incoming 8x6A SPMCB as outgoing to be partially recessed in wall.  | <b>2</b>  | <b>set</b>  |  |  |
| <b>12</b> | <b>LIGHTING DISTRIBUTION BOARD</b>  |           |             |  |  |

|           |   |    |      |  |  |
|-----------|---|----|------|--|--|
|           | Supply & installation of following HAVELLS/ LEGRAND make 16 way TPN MCB distribution board with MCB having shore circuit breaking capacity of 10KA or RCBO of 100 mA sensitivity having overload short circuit & earth leakage protection complete with neutral, phase & earth bar with 1 No. 40A DP RCBO as incoming 10x6A SPMCB as outgoing to be partially recessed in wall. | 1  | set  |  |  |
| <b>13</b> | <b>MAIN POWER CABLE</b>   |    |      |  |  |
| <b>a</b>  | Supplying, laying & fixing 4 core 50 sqmm PVC insulated, XLPE sheathed AL conductor, 1100 v grade armoured cable complete with 2 No's 8 SWG bear GI wire as running earth (main power cable).   | 10 | mtr. |  |  |
| <b>b</b>  | Supplying and fixing compression type gland, brass ring and rubber ring for dust & moisture-proof entry of XLPE/PVC armoured 4 core 50 sqmm cable.  | 2  | Each |  |  |
| <b>c</b>  | Supplying and fixing finishing 50 sqmm cable ends by soldering with cable sockets and insulated tapes etc. including supplying sockets. Soldering materials, tapes etc. and making connection to switch, BDB and BBC etc.   | 2  | Each |  |  |
| <b>14</b> | <b>GENERATOR CABLE</b>  |    |      |  |  |
| <b>a</b>  | Supplying laying & fixing 4 core 16 sqmm PVC insulated, XLPE sheathed AL conductor. 1100 v grade armoured cable complete with 2 Nos 8 SWG bear GI wire as running earth ( main power cable). (Make -Finolex/ havells/ Mescab/ Polycab/ KEI).  | 15 | mtr. |  |  |
| <b>b</b>  | Supplying and fixing compression type gland, brass ring and rubber ring for dust & moisture-proof entry of XLPE/PVC armoured 4 core 16 sqmm cable. (Make - Comet/ Braco/ Jainco)  | 2  | Each |  |  |
| <b>c</b>  | Supplying and fixing finishing of XLPE/PVC armoured 4 core 16 sqmm cable ends by soldering with cable sockets and insulated tapes etc. including supplying sockets. Soldering materials, tapes etc. and making connection to switch, BDB and BBC etc. (Male - Comet/ Braco/ Jainco)   | 2  | Each |  |  |
| <b>15</b> | <b>SUPPLY ITEMS</b>   |    |      |  |  |
| <b>a</b>  | Supply to CAT-6, 24 Port Patch Panel of GD Sole/D-Link Make   | 6  | Nos. |  |  |
| <b>b</b>  | Supply of 9U. Metal Rack with Glass door.   | 1  | Nos. |  |  |
| <b>c</b>  | Supply of CAT-6 1 Mtr. Patch Cord   | 5  | Nos. |  |  |
| <b>d</b>  | Supply of CAT-6 2 Mtr. Patch Cord   | 5  | Nos. |  |  |
| <b>16</b> | <b>INSTALLATION ITEMS</b>   |    |      |  |  |
| <b>a</b>  | Installation with crimping of to CAT-6, 24 Port Patch Panel of GD Sole/D-Link Make  | 6  | Nos. |  |  |
| <b>b</b>  | Installation on with fixing of of 9U. Metal Rack with Glass door.   | 1  | Nos. |  |  |
| <b>20</b> | <b>LIGHTING CUTT OFF</b>  |    |      |  |  |
|           | Supply & installing to 32A DP MCB with suitable size metal box complete (for Lighting Cut-off switch near bank entry/exit gate) for 2 nos. LDB CUTT OFF control. (Legrand make)   | 1  | set  |  |  |
| <b>17</b> | <b>UPS MAIN</b>   |    |      |  |  |
|           | Supply installing of 63 A 4 pole MCB with suitable size metal enclosure for UPS main control near UPS.  | 1  | set  |  |  |
| <b>18</b> | <b>METER LEED</b>   |    |      |  |  |
|           | Supply & Laying of 1100V grade 4 nos. 16 sqmm single more flexible copper wire in rigid PVC conduit/flexible pipe of suitable size from Meter to Kitkat & Kitkat to 125A SFU in meter spot WBSEB requirement.   | 10 | mtr. |  |  |

